

REV	LOCATIONS	DESCRIPTION	DATE	REVISER	APPD

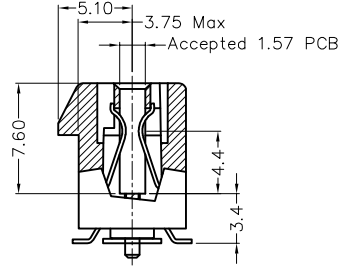
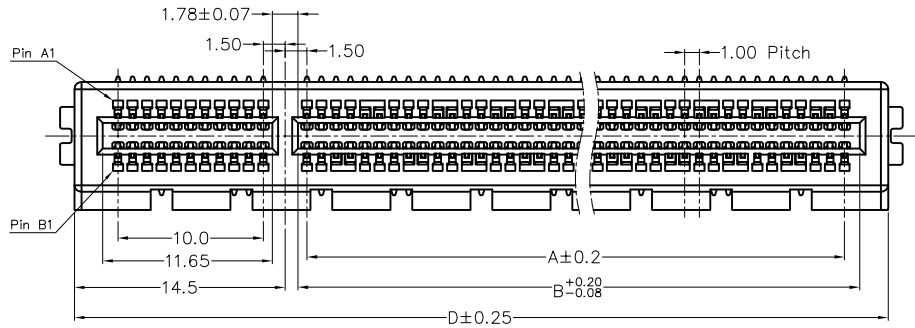

SECTION G-G

SPECIFICATIONS

Electrical
 Current Rating: 1.1A AC(rms)/DC
 Voltage Rating: 50V AC(rms)/DC
 Contact Resistance: 30mΩ Max
 Insulation Resistance: 1000MΩ Min
 Withstanding Voltage: 500V AC r.m.s
 Temperature Range-Operating: -40°C ~ +85°C

Material
 Housing: PA9T (UL 94V-0) Black
 Contact: Copper Alloy/ Selected gold plated on contact area, 100u" Min. matte Tin plated on solder tails
 Holddown: Copper Alloy/ 100u" Min. matte Tin Plated

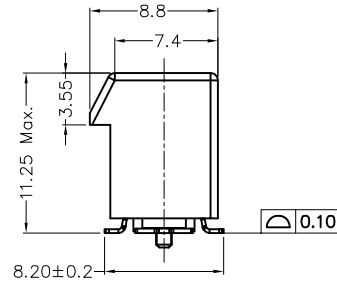
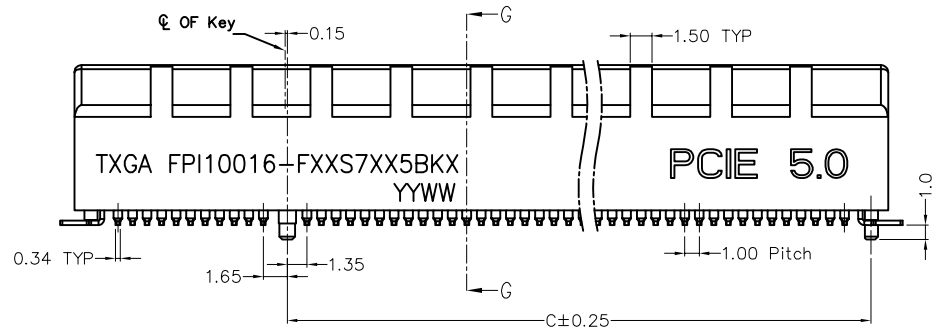

Ordering Information

FPI 100 16 - F XX S 7 XX 5 BK X
 1 2 3 4 5 6 7 8 9 10 11

1	Category FPI-PCIE	2	Series Number 100-Pitch1.00mm	3	Distinction No. 16	4	Type F-Female	5	Circuits XX	6	Entry Angle S-180° Vertical
7	Plating 7-Selective gold plated on contact area and matte tin plated on tails area	8	Thickness of Plating 00-Gold Flash 15-0.375µm 30-0.75µm	9	Material-Resin 5-PA9T	10	Color-Resin BK-Black	11	Packaging K-Tray M-Reel with cap W-Reel with mylar		

 THIRD ANGLE PROJECTION DESIGN UNITS METRIC(mm) SCALE 5:1 SIZE A4	GENERAL TOLERANCES (UNLESS SPECIFIED)		APPROVE BY LEO	DATE 10/SEP/24	PART NO. FPI10016-FXXS7XX5BKX	ITEM NO. FPI10016	 Building Technology Cornerstone REV 0 SHEET NO. 1/3
	X. ±0.30	X.* ±5°	CHECKED BY GISELLE	DATE 10/SEP/24	TITLE PCI Express Gen5(32GT/S) Pitch 1.0mm 180° Vertical SMT		
	X.X ±0.20	X.X* ±2°	DRAWN BY MATT	DATE 10/SEP/24	THIS DRAWING CONTAINS INFORMATION THAT IS PROPRIETARY TO TXGA INDUSTRIAL ELECTRONICS(S.Z)CO.,LTD AND SHOULD NOT BE USED WITHOUT WRITTEN PERMISSION		

REV	LOCATIONS	DESCRIPTION	DATE	REVISER	APPD

A

B

C

D

E

F

A

B

C

D

E

F

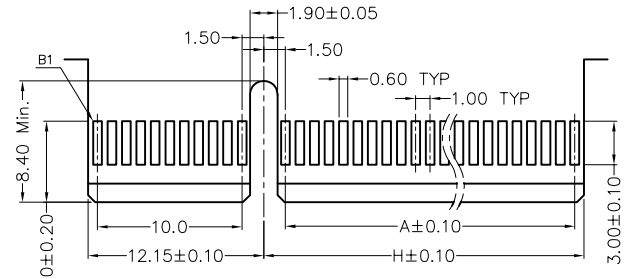

Recommended edge card pattern(Primary side)
General Tolerances: ±0.05mm

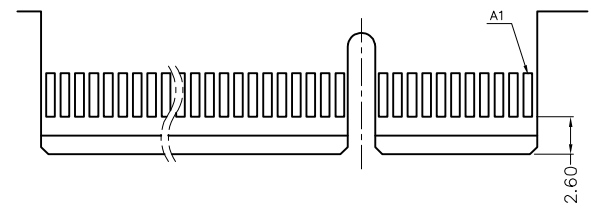
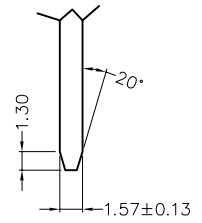

Recommended edge card pattern(Secondary side)
General Tolerances: ±0.05mm

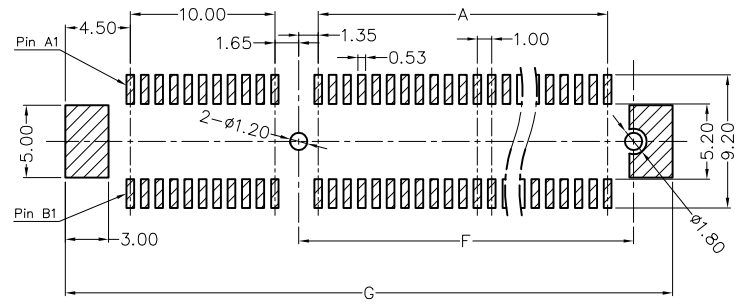

Recommended P.C.Board Layout
General Tolerances: ±0.05mm

Circuits(n)	Part No.	Dimensions (mm)							
		A	B	C	D	E	F	G	H
36	FPI10016-F36S7XX5BKX	6.0	7.65	9.15	25.0	27.0	9.15	28.0	8.15
64	FPI10016-F64S7XX5BKX	20.0	21.65	23.15	39.0	41.0	23.15	42.0	22.15
98	FPI10016-F98S7XX5BKX	37.0	38.65	40.15	56.0	58.0	40.15	59.0	39.15
164	FPI10016-F164S7XX5BKX	70.0	71.65	73.15	89.0	91.0	73.15	92.0	72.15

<p>THIRD ANGLE PROJECTION</p>	GENERAL TOLERANCES (UNLESS SPECIFIED)		APPROVE BY	DATE	PART NO.	ITEM NO.	<p>Building Technology Cornerstone</p>
	X. ±0.30	X.* ±5°	LEO	10/SEP/24	FPI10016-FXXS7XX5BKX	FPI10016	
	X.X ±0.20	X.X* ±2°	CHECKED BY	DATE	TITLE		
	X.XX ±0.15	X.XX* ±1°	GISELLE	10/SEP/24	PCI Express Gen5(32GT/S) Pitch 1.0mm 180° Vertical SMT		
SCALE	SIZE	X.XXX ±0.10	X.XXX* ±0.5°	DRAWN BY	DATE	THIS DRAWING CONTAINS INFORMATION THAT IS PROPRIETARY TO TXGA INDUSTRIAL ELECTRONICS(S.Z)CO.,LTD AND SHOULD NOT BE USED WITHOUT WRITTEN PERMISSION	
5:1	A4			MATT	10/SEP/24	REV 0	SHEET NO. 2/3

1 2 3 4 5 6 7 8

REV	LOCATIONS	DESCRIPTION	DATE	REVISER	APPD

A

36POS

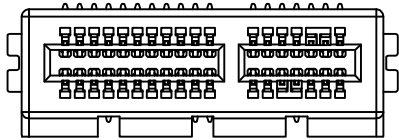

B

64POS

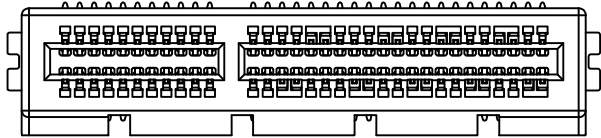

C

98POS

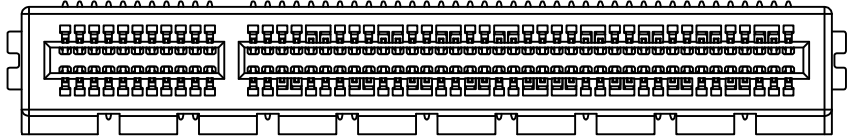

D

164POS

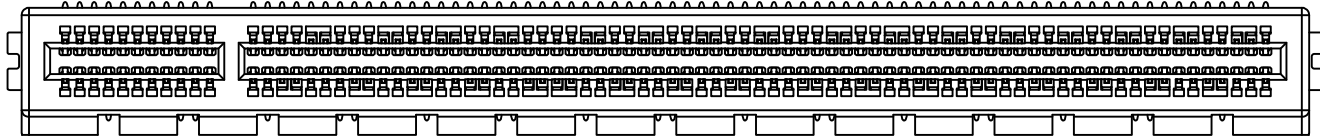

E

F

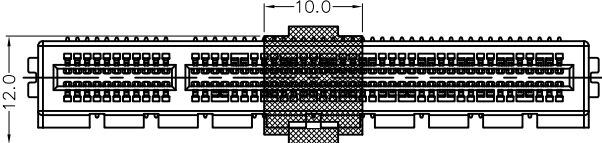

With CAP

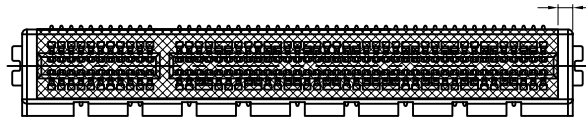

With Mylar

<p>THIRD ANGLE PROJECTION</p>	GENERAL TOLERANCES (UNLESS SPECIFIED)		APPROVE BY	DATE	PART NO.	ITEM NO.	<p>Building Technology Cornerstone</p>
	X. ±0.30	X.* ±5°	LEO	10/SEP/24	FP110016-FXXS7XX5BKX	FP110016	
	X.X ±0.20	X.X* ±2°	CHECKED BY	DATE	TITLE PCI Express Gen5(32GT/S) Pitch 1.0mm 180° Vertical SMT		
	X.XX ±0.15	X.XX* ±1°	GISELLE	10/SEP/24	REV 0	SHEET NO. 3/3	
SCALE 5:1	SIZE A4	X.XXX ±0.10	X.XXX* ±0.5°	DRAWN BY	DATE	THIS DRAWING CONTAINS INFORMATION THAT IS PROPRIETARY TO TXGA INDUSTRIAL ELECTRONICS(S.Z)CO.,LTD AND SHOULD NOT BE USED WITHOUT WRITTEN PERMISSION	
			MATT	10/SEP/24			

1 2 3 4 5 6 7 8